

KL12000V4 Stock Code Breakdown

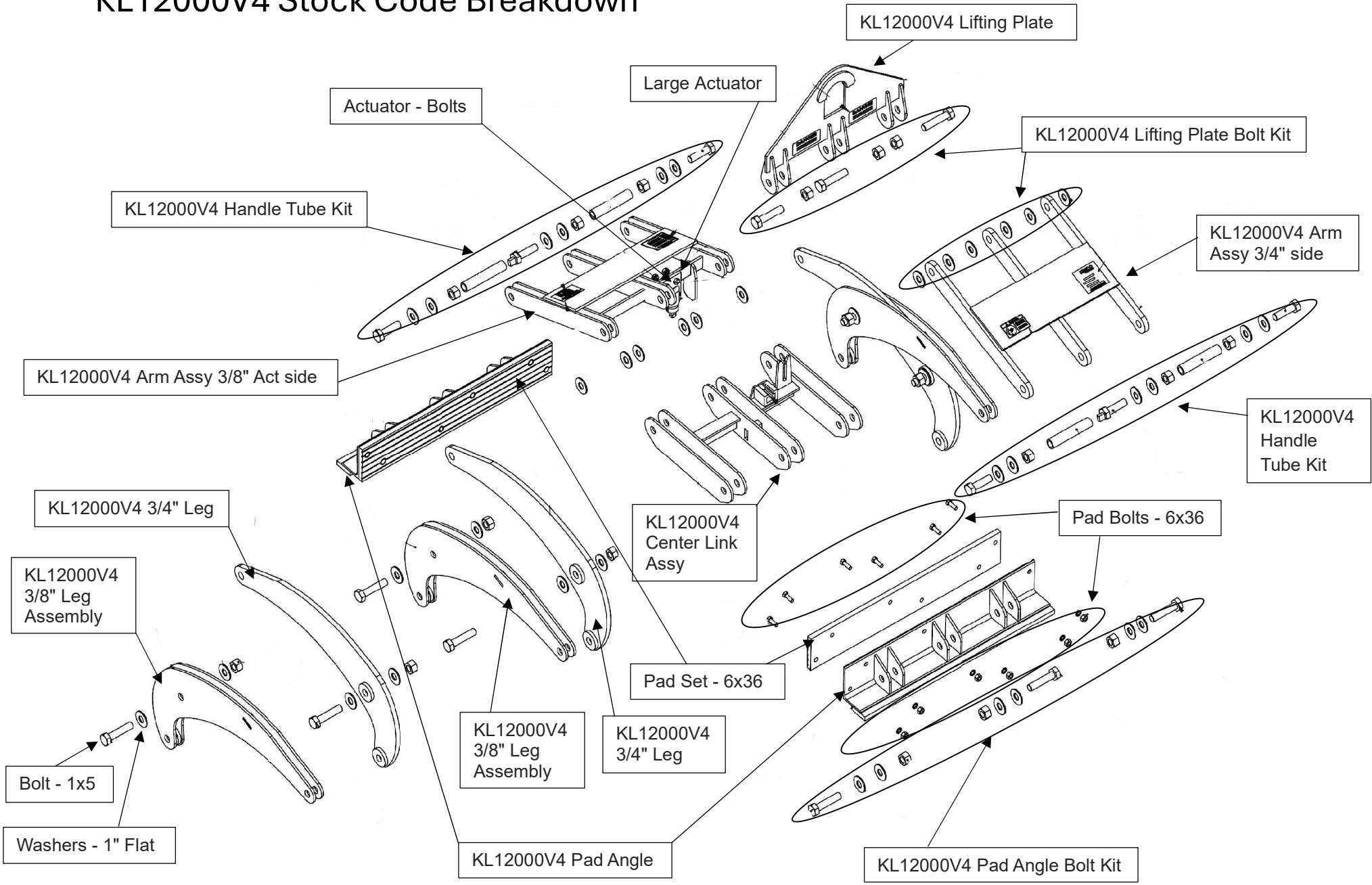

KL12000V4 Stock Code Breakdown

Stock Code	Includes
KL12000V4 Lifting Plate	1 Lifting Plate
KL12000V4 Lifting Plate Bolt Kit	3 Bolts & Nuts - 1"x5" & 12 Washers - 1"
KL12000V4 Arm Assy 3/8" Act side	1 Arm Assembly 3/8" (Actuator Side) & Top Actuator Alignment Guide
KL12000V4 Arm Assy 3/4" side	1 Arm Assembly 3/4"
KL12000V4 Center Link Assy	1 Center Link Assembly, Receiver Block, & Bottom Actuator Gide
KL12000V4 Handle Tube Kit*	1 Handle Tube Kit (3 Bolts & Nuts - 1"x4", six Washers - 1", & two Tubes - 7 1/4" & 7 1/2")
KL12000V4 3/8" Leg Assembly**	2 Legs - 3/8"
KL12000V4 3/4" Leg**	1 Leg - 3/4"
KL12000V4 Pad Angle	2 Pad Angles
KL12000V4 Pad Angle Bolt Kit	6 Bolts & Nuts - 1"x5" & 12 Washers - 1"
Pad Set - 6x36	2 Pads - 6"x36"
Pad Bolts - 6x36	12 Bolts, Nuts, & Washers - 1/2"x1 1/4"
Large Actuator	1 Large Actuator
Actuator - Bolts	2 Bolts, Nuts, & Washers - 1/2"x2"
Bolt - 1x5	1 Bolt & Nut - 1"x5" (15 per lifter)
Bolt - 1x4***	1 Bolt & Nut - 1"x4" (4 per lifter)
Washers - 1" Flat	1 Flat Washer - 1" (48 per lifter)
Actuator - KL-V4 Alignment Guide****	1 Actuator Alignment Guide (2pcs)
Serial Number Plate****	Serial Tag
Sticker Kit****	Safety Sticker Kit

*2 per lifter

**3 per lifter

***Included in the Handle Tube Kits

****Not labeled in drawing