

VUC Series Demolition Multi Processors

With crusher or pulverizer jaw, the VUC is the best solution for concrete, hard rock, and rebar processing. Unlike hydraulic breakers, the VUC processors provide noise-free and vibration-free solution to any demolition project. Large model selection is available for most carriers.

Dual Cylinder Dual Pin design provides

- Wide opening and tremendous initial crushing force, and optimized angle of attack.
- Asymmetric design and independent cylinder movement minimize the stress to the carrier.

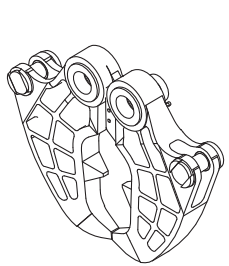
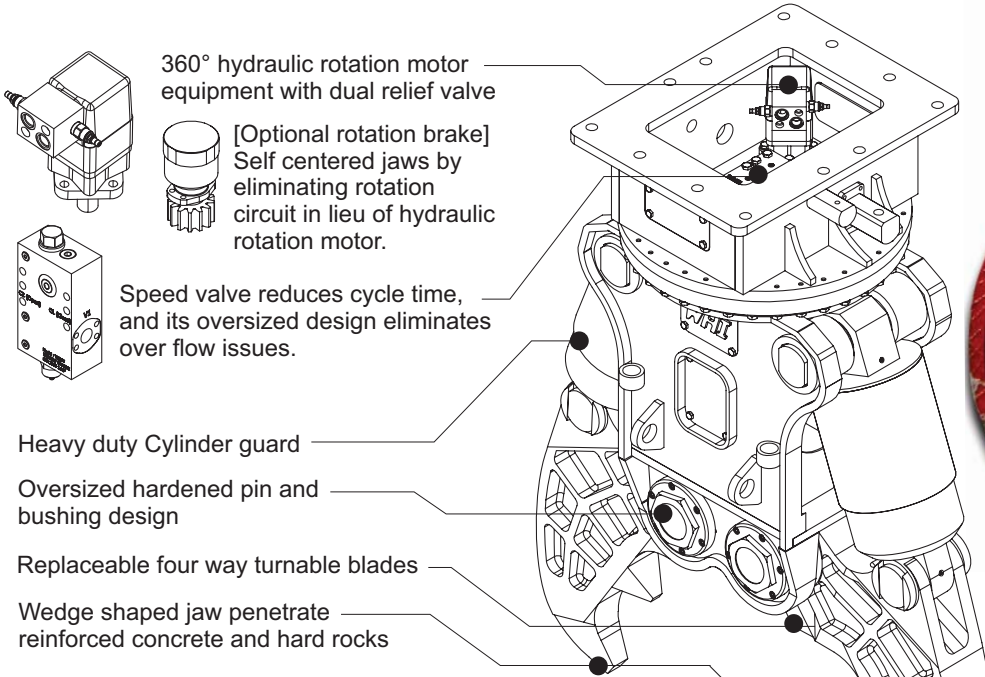

Crusher Jaw [CW Jaw]

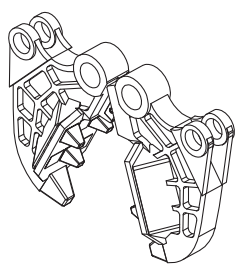

Pulverizer Jaw [PW Jaw]

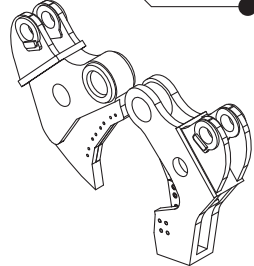

Shear Jaw [S Jaw]

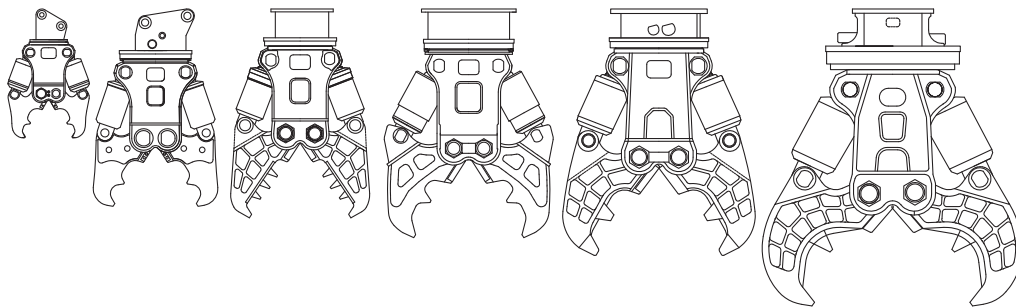

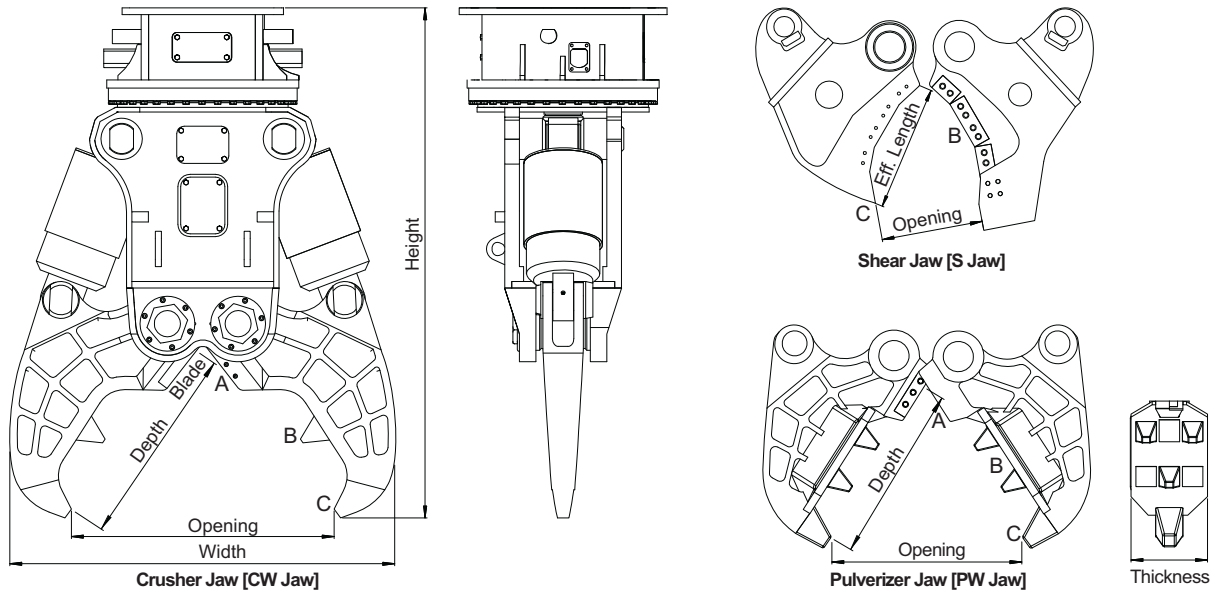

Model		Unit	VUC 152	VUC 182	VUC 202	VUC 302	Unit	VUC 152	VUC 182	VUC 202	VUC 302
Carrier Weight		M/T	13~20	17~23	20~40	29~45	M/T	13~20	17~23	20~40	29~45
Weight with CW Jaw		kg	1,365	1,580	2,100	2,750	lb	3,000	3,480	4,620	6,050
Weight with P Jaw			1,332	1,650	2,220	2,910		2,930	3,630	4,880	6,400
Weight with S Jaw			1,347	1,620	2,010	2,875		2,960	5,570	4,420	6,330
Crusher Dimensions [CW Jaw]	Height	mm	2,030	2,100	2,180	2,450	inch	80	83	86	96
	Width		1,250	1,280	1,450	1,720		49	50	57	68
	Opening		805	890	980	1,100		32	35	39	43
	Depth		610	790	820	945		24	31	32	37
	Blade Length		140	190	220	250		6	7	9	10
Pulverizer Dimensions [PW Jaw]	Height	mm	1,620	2,100	2,280	2,450	inch	64	83	90	96
	Width		1,120	1,280	1,450	1,720		44	50	57	68
	Opening		750	890	980	1,080		30	35	39	43
	Thickness		250	280	340	370		10	11	13	15
	Blade Length		140	190	220	250		6	7	9	10
Shear Dimensions [S Jaw]	Height	mm	1,650	1,830	2,150	2,280	inch	65	72	85	90
	Width		1,050	1,190	1,450	1,640		41	47	57	65
	Opening		390	430	514	520		15	17	20	20
	Depth		415	475	545	595		16	19	21	23
	Eff. Length		354	420	450	470		14	17	18	19
Cutting Force [A, Throat]		M/T (Metric Ton)	526	1,116	1,141	1,729	lb (X1000)	1,157	2,460	2,510	3,804
Crushing Force [CW/PW Jaw]	[B] Middle		128	202	254	326		281	443	558	718
	[C] Tip		82	111	143	180		181	244	314	396
Shearing Force [S Jaw]	[B] Apex		243	337	381	507		535	740	839	1,116
	[C] Tip	104	151	188	231	229	330	413	508		
Rated Pressure		bar	320				psi	4,600			
Rated Oil Flow		lpm	210	280	280	280	gpm	55	74		74
Hyd. Rotation	Pressure	bar	210				psi	3,000			
	Oil Flow	lpm	28~32	32~45	32~45	32~45	gpm	7~8	8~12		8~12
	Speed	RPM	10~15				RPM	10~15			
Cycle time	Open	sec	1.5	2.5	2.5	3.2	sec	1.5	2.5	2.5	3.2
	Close		1.4	2.3	2.3	3.8		1.4	2.3	2.3	3.8

Specifications subject to change without notice.

- Height Dim. : Flat top mounting. Measured jaw fully closed.
- Width Dim. : Measured jaw wide open.

- Cutting Force [A] : At rebar blade center
- Cycle time : Measured at rated flow under no load.