

STEEL CLAMP



- Stacking tubes on exist factory lines : 1" to 1" or 1-1/4"
- Anti-corrosion coated.



604-888-9020
sales@vanedequipment.com

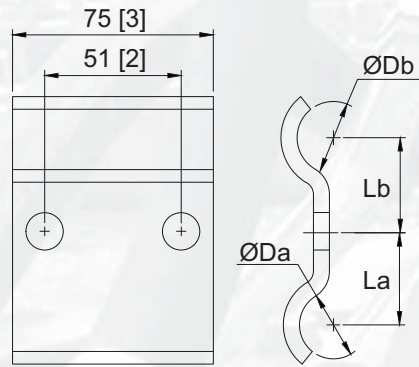

PID NO.	NOMINAL SIZE	Da	Db	La	Lb
411676G	1.25" + 1"	34	27.2	39	35
411674G	1" + 1"	27.2	34	35	35
1087550G	1.25" + 1.25"	34	34	39	39
7Y3732G	1.25" SINGLE	34	-	39	-

